

Specify **B2-LP**

PRODUCT	LED COLOR	COATING	LENS	CONNECTION	FINISH	LENGTH
	<b>Warm White</b> 27 -2700°K 30 -3000°K 35 -3500°K 40 -4000°K* <b>Cool White</b> 45 -4500°K* 50 -5000°K* *special order color	<b>U</b> -Uncoated <b>C</b> -Conformally Coated	<b>S</b> -Standard <b>O</b> -Opal Lens	<b>D</b> -Dead End <b>E</b> -End to End	<b>A</b> -Natural Clear <b>C</b> -Black* <b>D</b> -Medium Bronze* <b>O</b> -Custom* *Nonstandard finishes available for additional cost	3" Multiples

**Product Dimensions**

**End View -Actual Size**

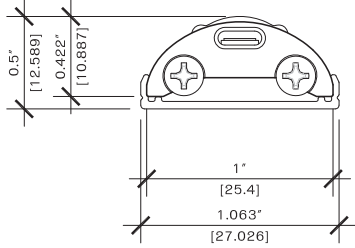

**Side and Top Views - 1/2 = 1**

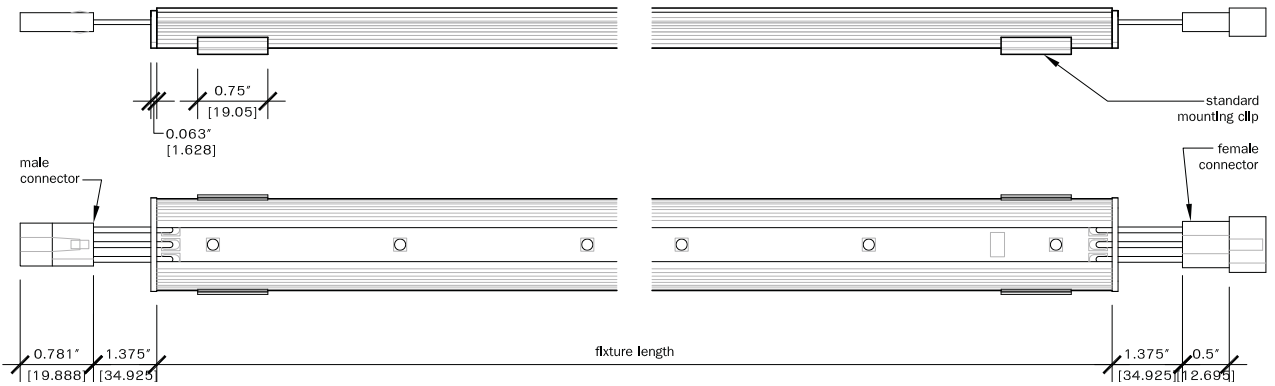

**Options**

**Lenses**

BriteLine2 Low Profile's housing incorporates a linear polycarbonate lens. This lens may be specified as standard clear or opal. Please contact your OptoLum Rep for custom options.

**Coating**

An optional conformal coating may be specified. This coating is optically clear and is applied over the circuitry and LEDs prior to final assembly to add a degree of protection to the circuit from environmental elements.

**Finishes and Mounting**

The standard BriteLine2 Low Profile Aluminium Housing comes with a natural anodized finish. Additional custom order anodized finishes are available for an additional cost.

**Control Systems**

BriteLine2 is compatible with most 0-10 dimming systems. All 0-10 interface devices and power supplies are ordered separately.

**Electrical**

OptoLum Low Voltage LED luminaires require OptoLum's remote power supplies, which must be ordered separately. BriteLine can be wired in series. Each power supply is provided with one 11'-0" lead.

Power Supply	W/ft	60W	96W
<b>B2 Round</b>	7.41	8'-0"	12'-0"

© OptoLum Inc. June 2014 - OptoLum reserves the right to change specifications for product improvement without notification

# BL2 Low Profile

Item	Specification	BL 3500K
<b>Output*</b>	Lumens/ft	524.33
	Efficacy	70.76 Lm/W
	CRI	CRI 85 nominal
	Lumen Maintenance	50,000 hours with maintenance of 70% lumen output @25 °C
<b>Electrical**</b>	Input Voltage	24 VDC
	Power Consumption	7.41 W/ft maximum at steady state
<b>Control</b>	Dimming	Compatible with most 0-10 systems with an OptoLum 0-10 dimming interface
<b>Physical</b>	Dimensions	1.0"W, 0.5"H, length 3" multiples
	Housing	Extruded aluminum, anodized finish
	Lens	Standard Clear or Opal
	Fixture connectors	End to End or Dead End
	Ambient Operating Temperature	-20 ° - 50 °C (-4 ° - 122 °F)
	Max fixture run length per power supply	12'-0" @ 96W 8'-0" @ 60W
<b>Certification and Safety</b>	Certification	UL, CE
	LED Class	Class 2 LED product
	Environment	Dry Location

© OptoLum Inc. June 2014 - OptoLum reserves the right to change specifications for product improvement without notification

\* Estimates have been included in the illumination data pending LM79 testing results; actual illumination may vary from these estimates.

\*\* Power consumption data does not include the power supply and may vary slightly.



## Lamp Life and Warranty

Average Rated Lamp Life is 50,000 hours. Lamp life is derived from a formula that includes known LED tolerance and actual stress applied. OptoLum warranties our products for three years from the date of purchase against manufacturing defects.